

# SYMBIOTE

## BV SERIES - BENCHTOP FUME HOOD

Customer Name: \_\_\_\_\_

Indicate Color: \_\_\_\_\_

Indicate Qty: \_\_\_\_\_

Work Order #: \_\_\_\_\_

Light Switch   Blower Switch   Blank Cover Plate   Alarm   *(Circle One)*

Indicate Plumbing Service - if none, leave blank \_\_\_\_\_

Indicate Plumbing Service - if none, leave blank \_\_\_\_\_

Indicate Plumbing Service - if none, leave blank \_\_\_\_\_

Indicate Plumbing Service - if none, leave blank \_\_\_\_\_

Indicate Plumbing Service - if none, leave blank \_\_\_\_\_

Blank   GFI Duplex   GFI Simplex   Std Duplex   Std Simplex   *(Circle One)*

### INTERIOR LINER OPTIONS

POLYRESIN (STANDARD)

STAINLESS STEEL T304

FIXED BAFFLE (NON STANDARD)

### PLUMBING PRE-PIPING

PRE-PIPE DOWN

PRE-PIPE UP

### LIGHTING OPTIONS

LED (STANDARD)

EXPLOSION PROOF LIGHT

### BLOWER

BLOWER NEEDED

### CABINET OPTIONS

ACID

FLAMMABLE

HOOD BASE

SINK BASE

### ADDITIONAL OPTIONS

ADA FRONT POST CONFIG

CEILING ENCL. (height\_\_\_\_")

SASH STOPS

CORROSION RESISTANT HARDWARE

### ALARM & CONTROLLER OPTIONS

AFA 500 AIRFLOW MONITOR

AFA 1000 AIRFLOW MONITOR W/DIGITAL DISPLAY

AFA 4000/2 VAV CONTROLLER

SASH ALARM

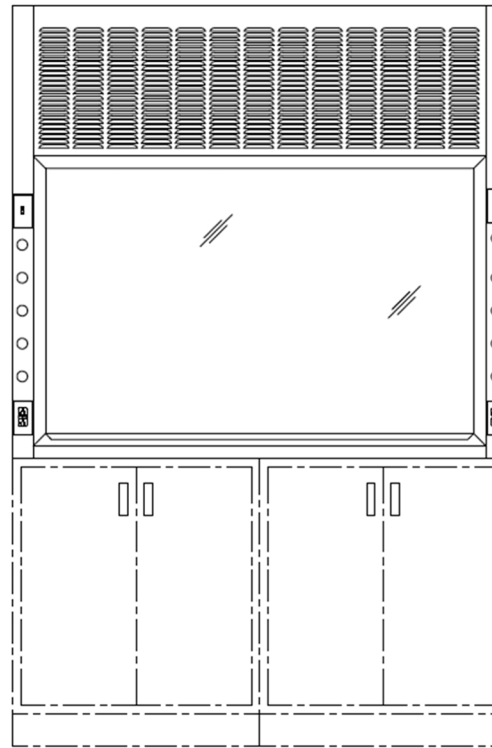

LENGTH (CHOOSE ONE)

36"    48"    60"    72"    96"

### COLOR



Light Switch   Blower Switch   Blank Cover Plate   Alarm   *(Circle One)*

Indicate Plumbing Service - if none, leave blank \_\_\_\_\_

Indicate Plumbing Service - if none, leave blank \_\_\_\_\_

Indicate Plumbing Service - if none, leave blank \_\_\_\_\_

Indicate Plumbing Service - if none, leave blank \_\_\_\_\_

Indicate Plumbing Service - if none, leave blank \_\_\_\_\_

Blank   GFI Duplex   GFI Simplex   Std Duplex   Std Simplex   *(Circle One)*

### SASH CONFIGURATION

VERTICAL SASH (STANDARD)

HORIZONTAL SASH

COMBINATION SASH

INTERLOCKING SASH